

## Air Flow Capture Hood

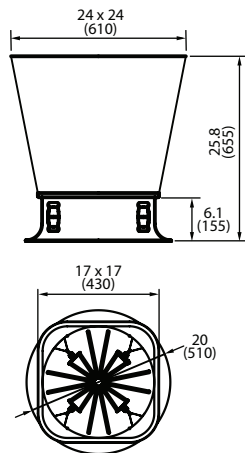

### DIMENSIONS



### SPECIFICATIONS

**Service:** Air

**Volume Flow Range:** 50 to 2000 CFM (85 to 3400 M3/h)

**Volume Flow Resolution:** 0.1

**Velocity Range:** 39 to 1500 FPM (0.2 to 7.6 m/s)

**Velocity Resolution:** 0.1

**Temperature Range:** 14° to 176°F (-10° to 80°C)

**Temperature Resolution:** 0.1°

**Accuracy:**

**Supply Volume Flow:** ±3% of reading ±7 CFM

**Exhaust Volume Flow:** ±4% of reading ±7 CFM

**Temperature:** ±0.5% of reading ±1°F

**Display:** 128 x 64 matrix LCD

**Output:** RS-232

**Memory:** 100 readings, non-volatile

**Power Requirements:** (3) AA batteries (included)

**Battery Life:** 10+ hour continuous operation

**Weight:** 8.8 lb (4 kg)

- Light Weight
- 100 Reading Memory
- Large LCD Display
- Accuracy 3%
- Cable and Software for Data Download Included
- Measures Flow, Velocity and Temperature
- Supply or Exhaust Measurement

The Series VF Air Flow Capture Hood accurately measures air volume flowing through registers, diffusers and grills. The Air Flow Capture Hood is light weight and is easily handled by one person for measuring supply or exhaust airflow. The large LCD simultaneously displays airflow, velocity and temperature and can store up to 100 readings in a non volatile memory for later analysis. Later analysis of the Air Flow Capture Hood data is easily downloaded to your computer with the included RS-232 cable and software. Each Series VF Air Flow Capture Hood includes airflow measuring base, 2' x 2' (610 mm) hood, brackets, RS-232 cable, software, nylon carrying case, batteries, and calibration data sheet.

### MODEL NUMBERS

**VF01B** – Air Flow Capture Hood includes

- Base
- 2' x 2' hood (610 x 610 mm)
- VF01 software
- RS-232 cable
- Calibration certificate
- Nylon carrying case

**CH2** – 2' x 4' hood expansion kit (610 x 1220 mm)

**CH3** – 1' x 4' hood expansion kit (305 x 1220 mm)